

05/08/99

CONTRACT NO.: DA00214 WBS ELEMENT: ICR.20081.68, ETC.

STATE OF NORTH CAROLINA
DIVISION OF HIGHWAYS

BERTIE COUNTY

LOCATION: MAP 1 SR 1502 FROM NC 45 TO END
MAP 2 SR 1363 FROM SR 1364 TO NC 45
MAP 3 SR 1322 FROM SR 1321 TO HERTFORD CO. LINE
MAP 4 SR 1342 FROM SR 1312 TO SR 1314
MAP 5 SR 1254 FROM NC 11 TO END
MAP 6 SR 1228 FROM SR 1229 TO SR 1246

TYPE OF WORK: ASPHALT SURFACE TREATMENT & RESURFACING

STATE	STATE PROJECT REFERENCE NO.	SHEET NO.	TOTAL SHEETS
N.C.	1CR.20081.68, ETC.	1	9
STATE PROJ. NO.	F.A. PROJ. NO.	DESCRIPTION	
1CR.20081.68		MAP 1	
1CR.20081.69		MAP 2	
1CR.20081.70		MAP 3	
1CR.20081.71		MAP 4	
1CR.20081.72		MAP 5	
1CR.20081.73		MAP 6	

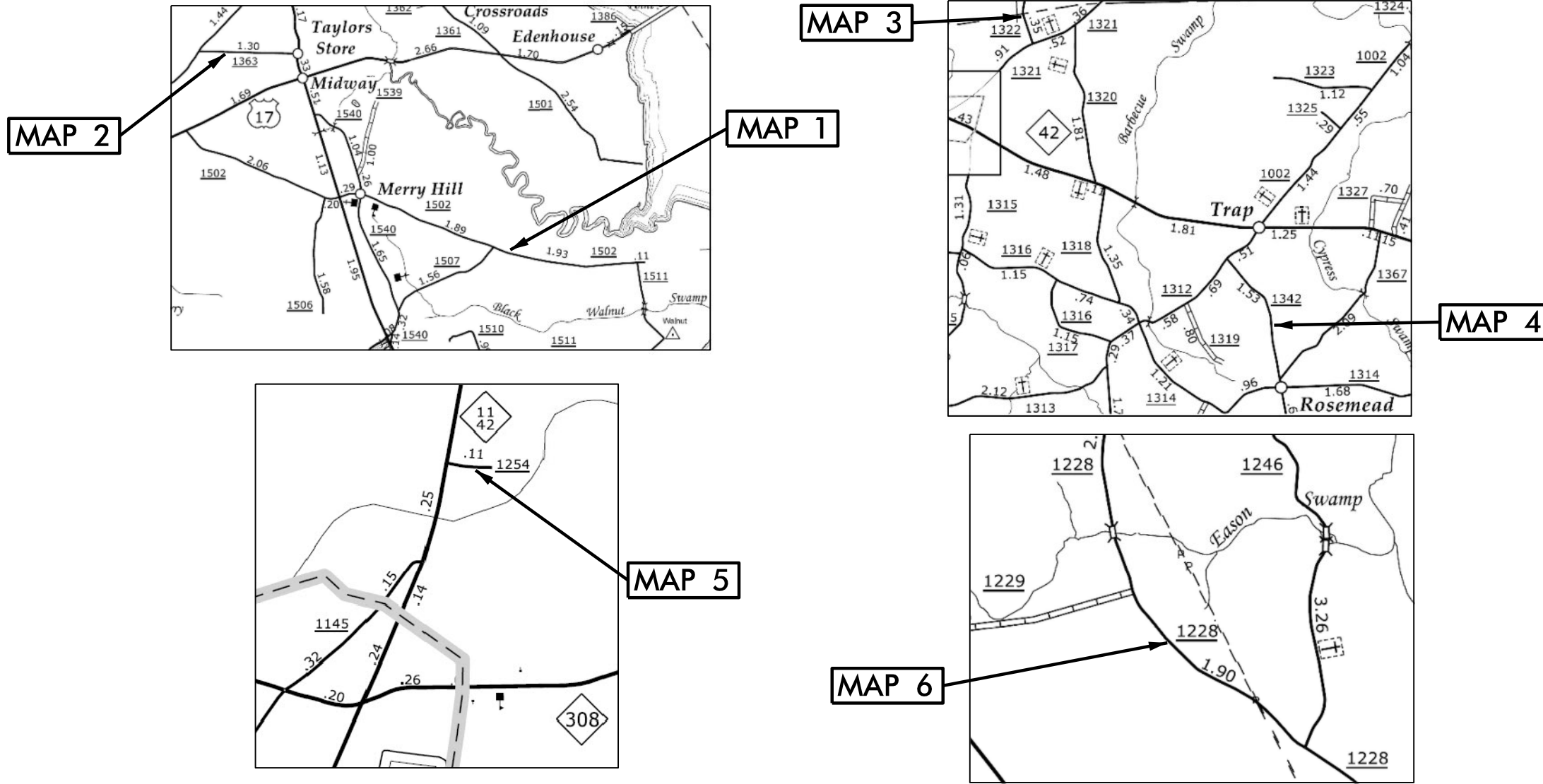

NTS

PROJECT LENGTH

LENGTH OF ROADWAY PROJECT MAP 1	= 4.14 MI.
LENGTH OF ROADWAY PROJECT MAP 2	= 1.25 MI.
LENGTH OF ROADWAY PROJECT MAP 3	= 0.43 MI.
LENGTH OF ROADWAY PROJECT MAP 4	= 1.63 MI.
LENGTH OF ROADWAY PROJECT MAP 5	= 0.13 MI.
LENGTH OF ROADWAY PROJECT MAP 6	= 1.90 MI.

Prepared In the Office of:
DIVISION OF HIGHWAYS
113 Airport Dr., Edenton NC, 27932

2012 STANDARD SPECIFICATIONS

LETTING DATE:
OCTOBER 1, 2014

W.B. HOBBS, P.E.
DIVISION PROJECT MANAGER

C.E. SLACHTA
DIVISION PROPOSALS ENGINEER

**DIVISION OF HIGHWAYS
STATE OF NORTH CAROLINA**

09/08/09

CONTRACT NO.: DA00214 WBS ELEMENT: ICR.20081.68, ETC.

STATE OF NORTH CAROLINA
DIVISION OF HIGHWAYS

HERTFORD COUNTY

LOCATION: MAP 7 SR 1409 FROM MALIBU DR. TO SR 1101
 MAP 8 SR 1403 FROM SR 1400 TO NC 45
 MAP 9 SR 1141 FROM SR 1146 TO SR 1146
 MAP 10 SR 1427 FROM SR 1429 TO NC 561
 MAP 11 SR 1220 FROM NC 561 TO END

STATE	STATE PROJECT REFERENCE NO.	SHEET NO.	TOTAL SHEETS
N.C.	ICR.20081.68, ETC.	2	9
STATE PROJ. NO.	F.A. PROJ. NO.	DESCRIPTION	
ICR.20461.58		MAP 7	
ICR.20461.59		MAP 8	
ICR.20461.60		MAP 9	
ICR.20461.61		MAP 10	
ICR.20461.62		MAP 11	

TYPE OF WORK: ASPHALT SURFACE TREATMENT, MILLING, & RESURFACING

MAP 7

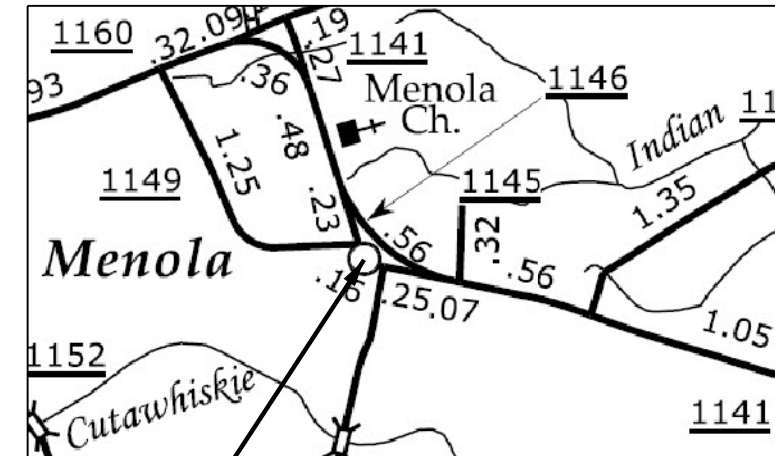
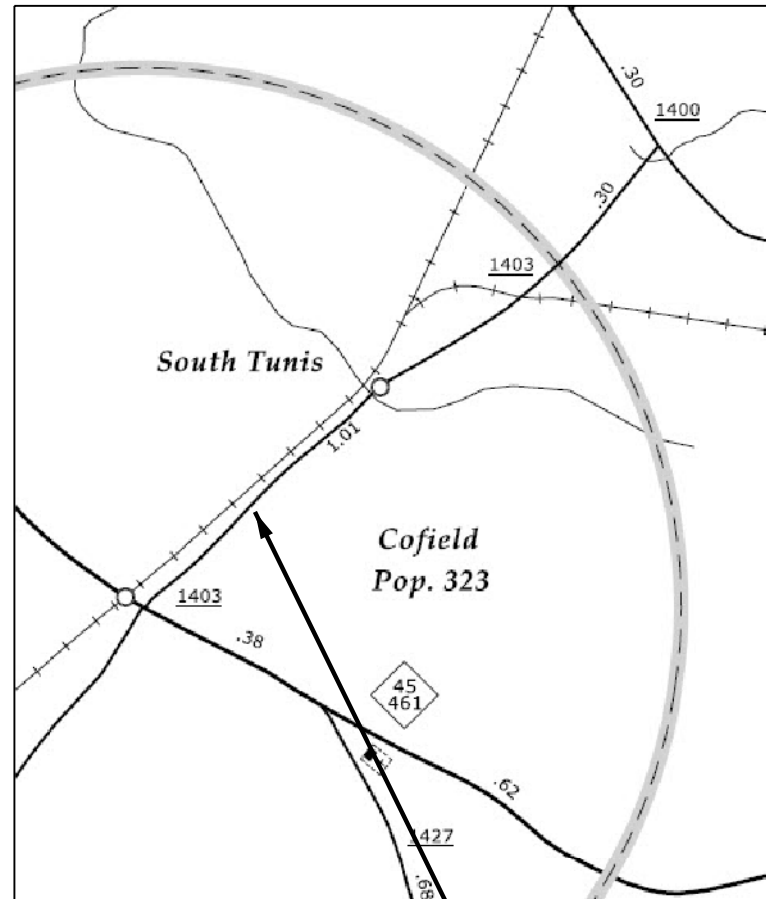
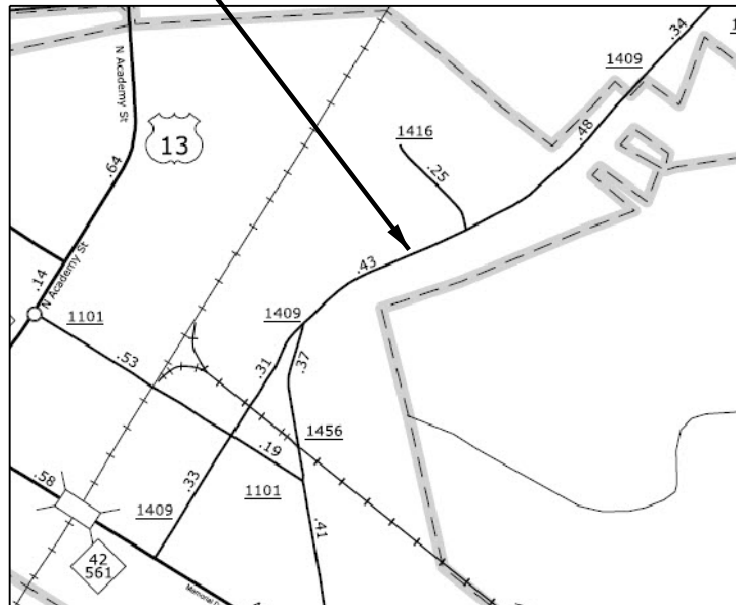

MAP 9

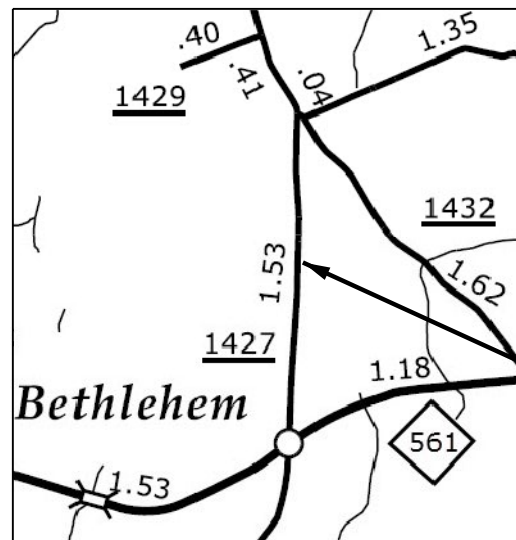

MAP 10

MAP 8

MAP 11

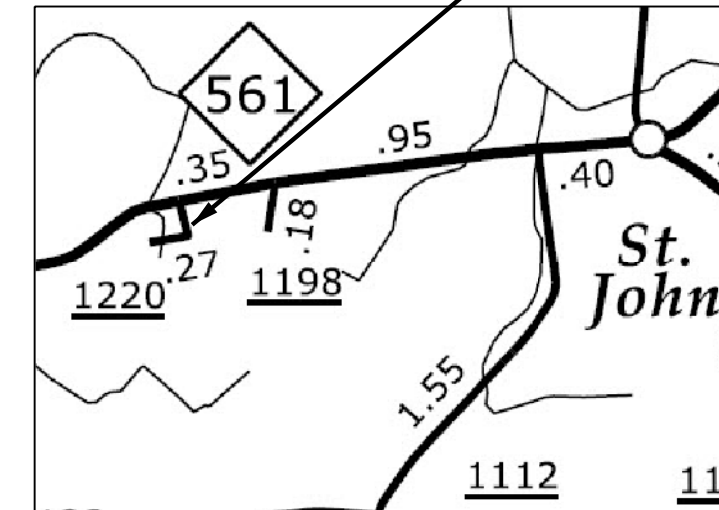

NTS

PROJECT LENGTH

LENGTH OF ROADWAY PROJECT MAP 7 = 1.21 MI.
 LENGTH OF ROADWAY PROJECT MAP 8 = 1.28 MI.
 LENGTH OF ROADWAY PROJECT MAP 9 = 0.56 MI.
 LENGTH OF ROADWAY PROJECT MAP 10 = 1.93 MI.
 LENGTH OF ROADWAY PROJECT MAP 11 = 0.25 MI.

Prepared In the Office of:
DIVISION OF HIGHWAYS
 113 Airport Dr., Edenton NC, 27932

2012 STANDARD SPECIFICATIONS

LETTING DATE:
 OCTOBER 1, 2014

W.B. HOBBS, P.E.
 DIVISION PROJECT MANAGER

C.E. SLACHTA
 DIVISION PROPOSALS ENGINEER

DIVISION OF HIGHWAYS
 STATE OF NORTH CAROLINA

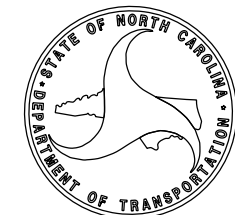

05/08/99

CONTRACT NO. : DA00214 WBS ELEMENT: ICR.20081.68, ETC.

STATE OF NORTH CAROLINA
DIVISION OF HIGHWAYS

NORTHAMPTON COUNTY

LOCATION: MAP 12 SR 1505 FROM US 158 TO SR 1504
 MAP 13 SR 1314 FROM NC 305 TO SR 1311
 MAP 14 SR 1218 FROM NC 46 TO SR 1613
 MAP 15 SR 1219 FROM SR 1209 TO END
 MAP 16 SR 1274 FROM SR 1263 TO END
 MAP 17 SR 1294 FROM SR 1274 TO END
 MAP 18 SR 1275 FROM SR 1274 TO END
 MAP 19 SR 1276 FROM SR 1275 TO END

TYPE OF WORK: ASPHALT SURFACE TREATMENT & RESURFACING

STATE	STATE PROJECT REFERENCE NO.	SHEET NO.	TOTAL SHEETS
N.C.	ICR.20081.68, ETC.	3	9
STATE PROJ. NO.	F.A. PROJ. NO.	DESCRIPTION	
1CR.20661.95		MAP 12	
1CR.20661.96		MAP 13	
1CR.20661.97		MAP 14	
1CR.20661.98		MAP 15	
1CR.20661.99		MAP 16	
1CR.20661.100		MAP 17	
1CR.20661.101		MAP 18	
1CR.20661.102		MAP 19	

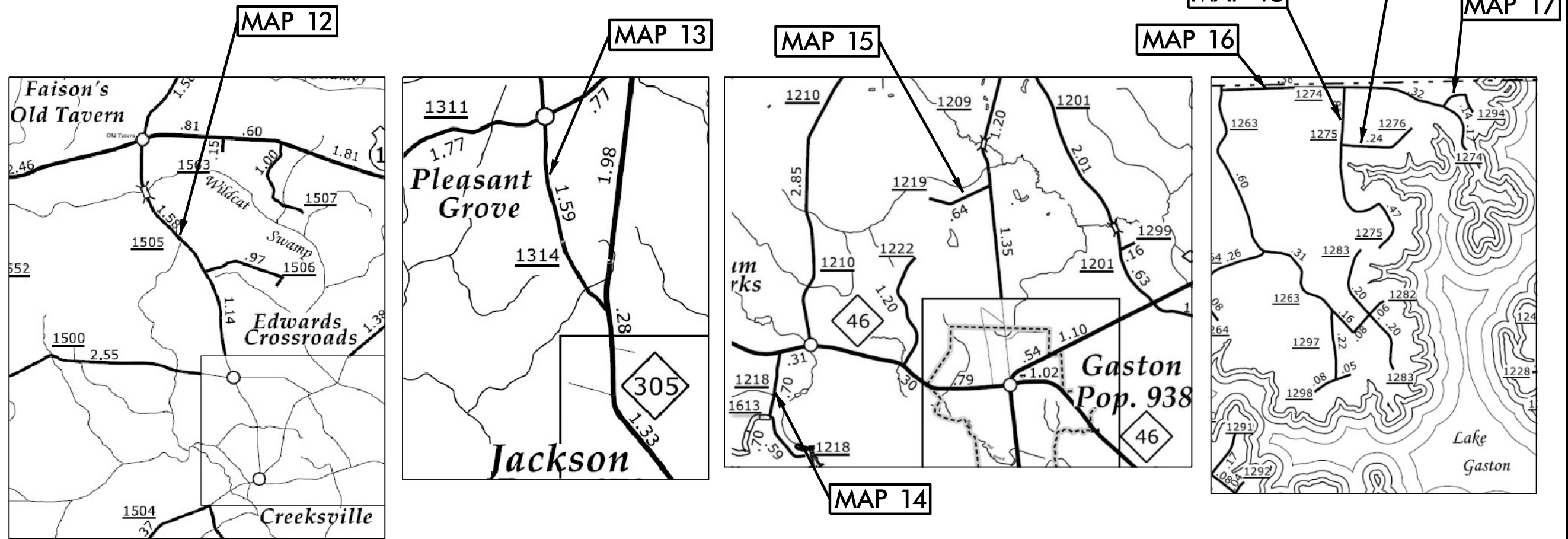

NTS

PROJECT LENGTH	
LENGTH OF ROADWAY PROJECT	MAP 12 = 3.80 MI.
LENGTH OF ROADWAY PROJECT	MAP 13 = 1.56 MI.
LENGTH OF ROADWAY PROJECT	MAP 14 = 0.62 MI.
LENGTH OF ROADWAY PROJECT	MAP 15 = 0.64 MI.
LENGTH OF ROADWAY PROJECT	MAP 16 = 0.87 MI.
LENGTH OF ROADWAY PROJECT	MAP 17 = 0.14 MI.
LENGTH OF ROADWAY PROJECT	MAP 18 = 0.64 MI.
LENGTH OF ROADWAY PROJECT	MAP 19 = 0.24 MI.

Prepared In the Office of:
DIVISION OF HIGHWAYS
 113 Airport Dr., Edenton NC, 27932

2012 STANDARD SPECIFICATIONS

LETTING DATE:
OCTOBER 1, 2014

W.B. HOBBS, P.E.
DIVISION PROJECT MANAGER

C.E. SLACHTA
DIVISION PROPOSALS ENGINEER

DIVISION OF HIGHWAYS
STATE OF NORTH CAROLINA

PAVEMENT SCHEDULE

C1	PROP. APPROX. 1.5" ASPHALT CONCRETE SURFACE COURSE, TYPE S9.5B, AT AN AVERAGE RATE OF 168 LBS. PER SQ. YD.
U	EXISTING PAVEMENT.

PROJECT REFERENCE NO. 1CR.20081.68, ETC.	SHEET NO. 4 of 9
--	----------------------------

NOTES:

- *ALL PAVED S.R. ROADS TO BE RESURFACED TO THE ENDS OF THE RADII., OR AS DIRECTED BY THE ENGINEER
- *EDGES, PAVEMENT WIDENING, INTERSECTIONS, AND BRIDGE FLARES ARE INCLUDED IN THE SUMMARY OF QUANTITIES
- *SHOULDER RECONSTRUCTION TO BE PERFORMED BY OTHERS
- *PAVEMENT MARKINGS TO BE PERFORMED BY OTHERS
- *ON MAP 8 CONTRACTOR SHALL MILL 1.5" BELOW EXISTING EDGE OF SHORT SECTION OF CONC. CURB & GUTTER.
- *BRIDGE ON MAP 12 TO BE MILLED 3.5" AND RESURFACED WITH 1.5" OF S9.5B MIX PER NCDOT BRIDGE MAINTENANCE UNIT.

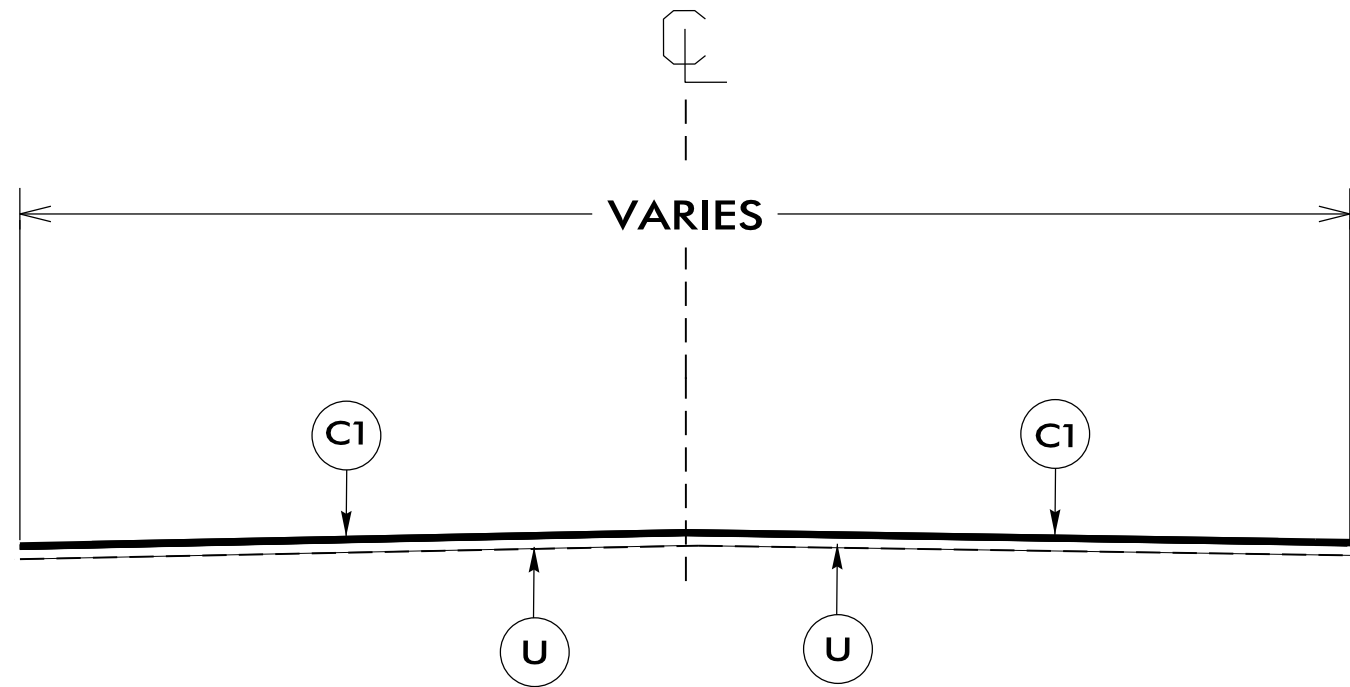

TYPICAL SECTION NO. 1

USE WITH MAPS 1, 8, & 12

NTS

05-SEP-2014 10:53 C:\Users\c... DIVISION PROJECT WORKING FILES\District Two\DA00214 Bertie, Hertford & Northampton Co. (2015)\1.Pre-Bid Documents\DA00214 Plans (Plan Sheets 1-7).dgn

PAVEMENT SCHEDULE

C2	PROP. APPROX. 1.25" ASPHALT CONCRETE SURFACE COURSE, TYPE SF9.5A, AT AN AVERAGE RATE OF 137.5 LBS. PER SQ. YD.
C3	PROP. ASPHALT SURFACE TREATMENT, SPLIT SEAL, AT AN APPLICATION RATE PER NCDOT 2012 STANDARD SPECIFICATIONS
U	EXISTING PAVEMENT.

PROJECT REFERENCE NO.	SHEET NO.
1CR.20081.68, ETC.	5 of 9

NOTES:

*ALL PAVED S.R. ROADS TO BE RESURFACED TO THE ENDS OF THE RADII., OR AS DIRECTED BY THE ENGINEER

*EDGES, PAVEMENT WIDENING, INTERSECTIONS, AND BRIDGE FLARES ARE INCLUDED IN THE SUMMARY OF QUANTITIES

*SHOULDER RECONSTRUCTION TO BE PERFORMED BY OTHERS

*PAVEMENT MARKINGS TO BE PERFORMED BY OTHERS

*ASPHALT SURFACE TREATMENT SHALL BE ALLOWED TO SET UP FOR A MINIMUM 10 DAYS BEFORE ANY OTHER WORK CAN BE PERFORMED

*ON MAP 10 (SR 1427), ASPHALT SURFACE TREATMENT TO ONLY BE INSTALLED FROM NC 561 TO APPROXIMATELY 1 MILE NORTH

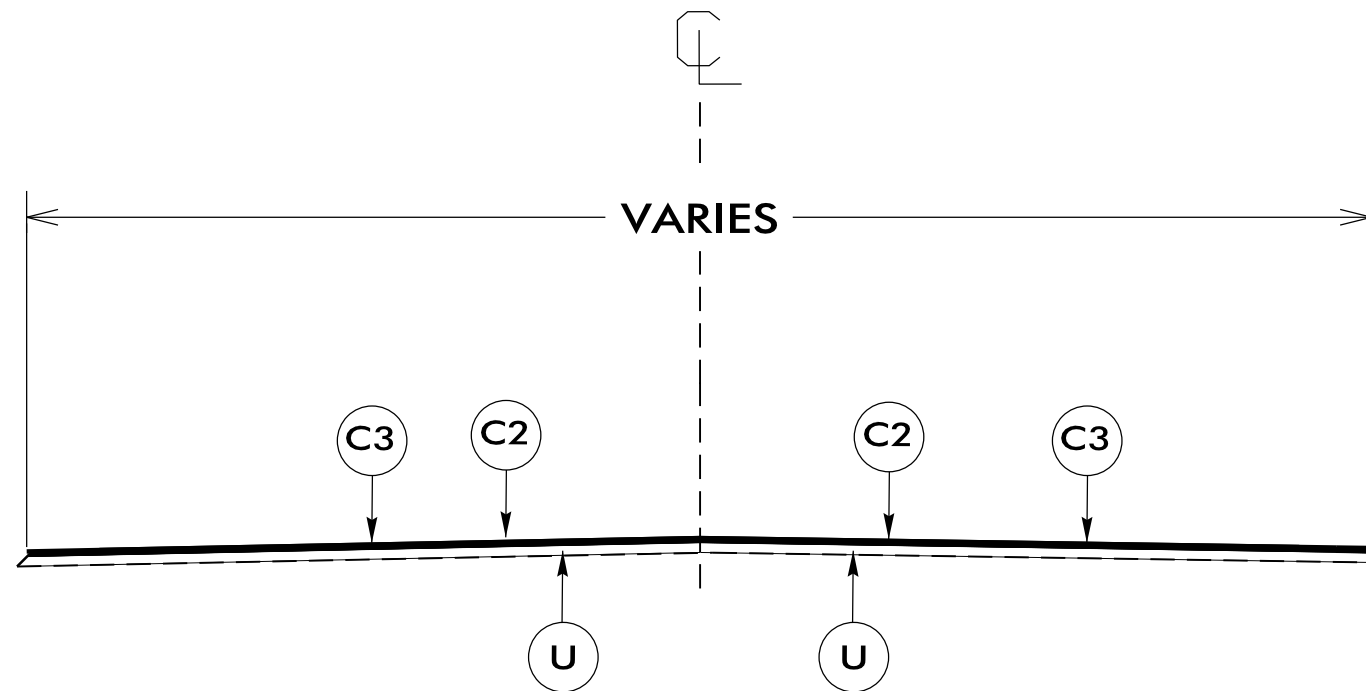

TYPICAL SECTION NO. 2
USE WITH MAPS 2, 4, 9, 10, & 13

NTS

05-SEP-2014 10:01 AM C:\Users\jdivison\Documents\Projects\Working Files\District Two\DA00214 Bertus, Hertford & Northampton Co. (2015)\1-Pre-Bid Documents\DA00214 Plans (Plan Sheets 1-7).dgn

PAVEMENT SCHEDULE

C2	PROP. APPROX. 1.25" ASPHALT CONCRETE SURFACE COURSE, TYPE SF9.5A, AT AN AVERAGE RATE OF 137.5 LBS. PER SQ. YD.
U	EXISTING PAVEMENT.

PROJECT REFERENCE NO.	SHEET NO.
1CR.20081.68, ETC.	6 of 9

NOTES:

- *ALL PAVED S.R. ROADS TO BE RESURFACED TO THE ENDS OF THE RADII, OR AS DIRECTED BY THE ENGINEER
- *EDGES, PAVEMENT WIDENING, INTERSECTIONS, AND BRIDGE FLARES ARE INCLUDED IN THE SUMMARY OF QUANTITIES
- *SHOULDER RECONSTRUCTION TO BE PERFORMED BY OTHERS
- *PAVEMENT MARKINGS TO BE PERFORMED BY OTHERS

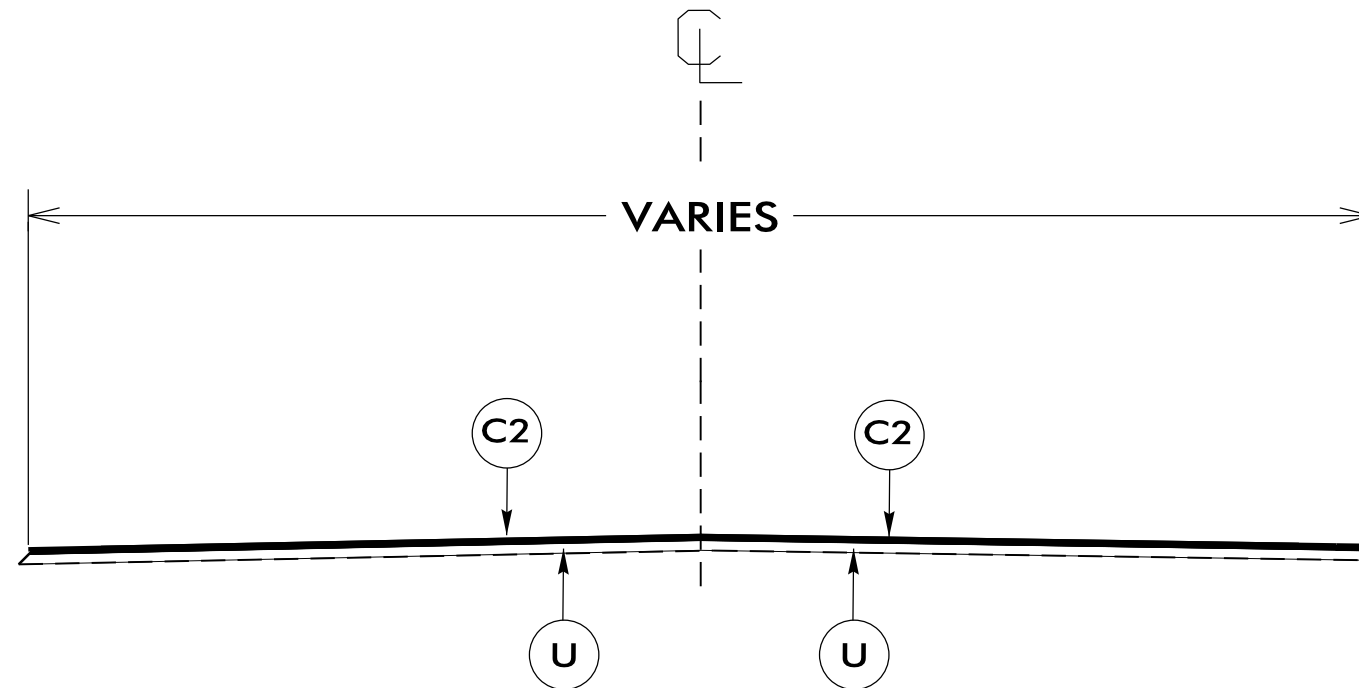

TYPICAL SECTION NO. 3

USE WITH MAPS 3, 5, 6, 11, & 14-19

NTS

PAVEMENT SCHEDULE

C1	PROP. APPROX. 1.5" ASPHALT CONCRETE SURFACE COURSE, TYPE S9.5B, AT AN AVERAGE RATE OF 168 LBS. PER SQ. YD.
V1	MILLING BITUMINOUS PAVEMENT. 1.5" IN DEPTH.
U	EXISTING PAVEMENT.

NOTES:

- *ALL PAVED S.R. ROADS TO BE RESURFACED TO THE ENDS OF THE RADII., OR AS DIRECTED BY THE ENGINEER
- *EDGES, PAVEMENT WIDENING, INTERSECTIONS, AND BRIDGE FLARES ARE INCLUDED IN THE SUMMARY OF QUANTITIES
- *CONTRACTOR SHALL MILL 1.5" BELOW EXISTING EDGE OF CONC. CURB & GUTTER.
- *PAVEMENT MARKINGS TO BE PERFORMED BY OTHERS
- *INDUCTIVE LOOPS SHALL BE INSTALLED PRIOR TO THE FINAL LIFT OF SURFACE BEING PLACED

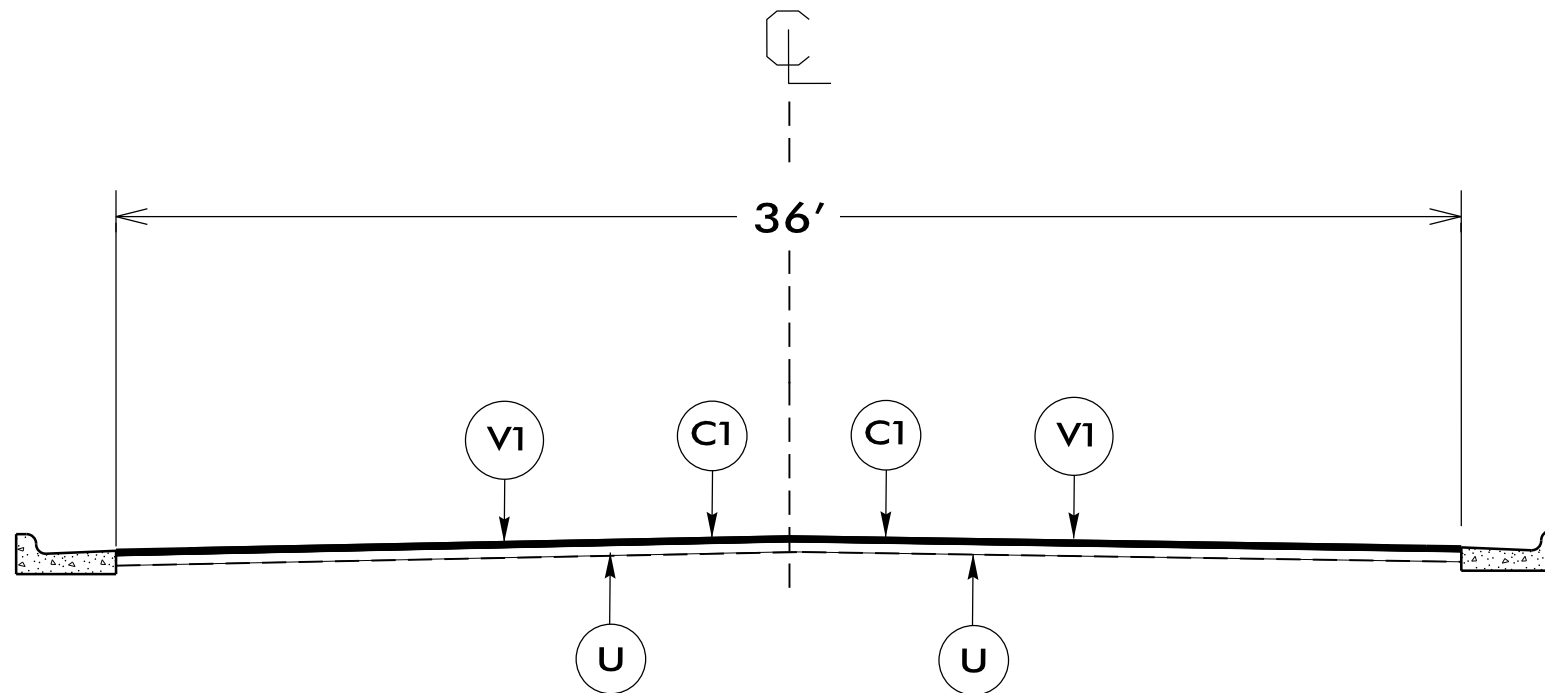

TYPICAL SECTION NO. 4

USE WITH MAP 7

NTS

- NOTES:
- 1) DETAIL DOES NOT APPLY TO OGAFc AND ULTRA-THIN BONDED WEARING COURSE.
 - 2) BACKFILL SHOULDER WITH APPROVED MATERIAL.
 - 3) THE SHOULDER WEDGE DEVICE MAY BE DISENGAGED AT PAVED DRIVEWAYS AND SIDE STREETS.

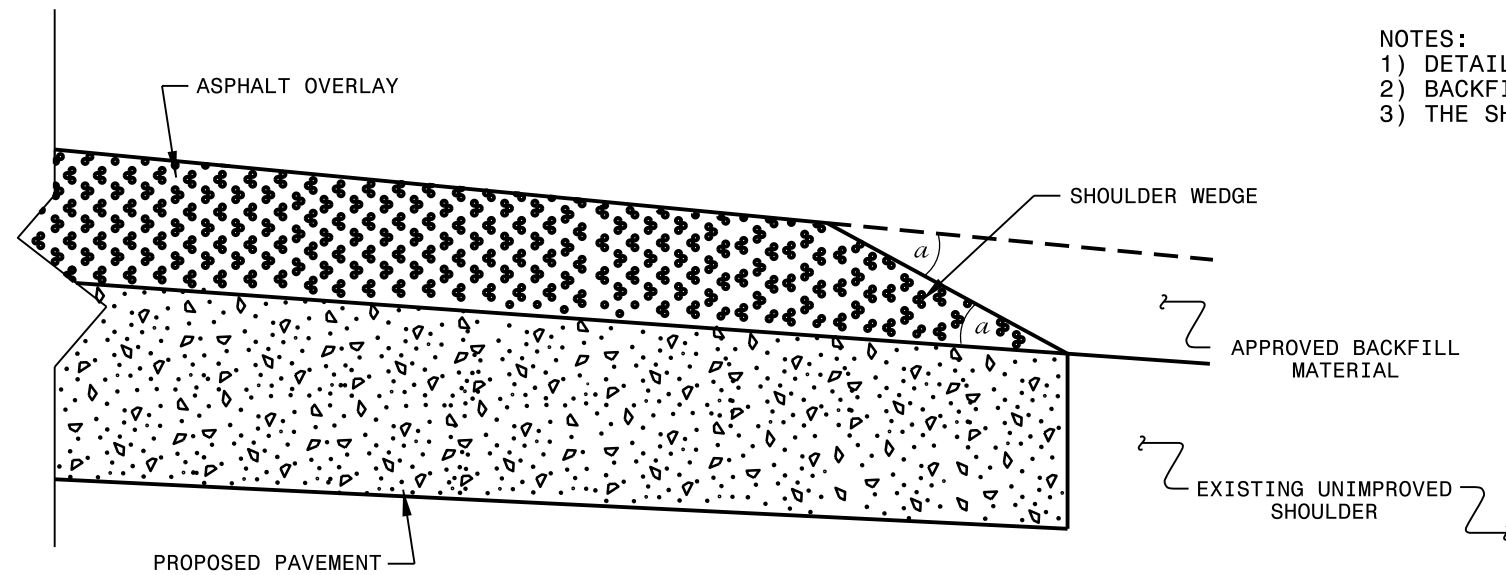

SHOULDER WEDGE DETAIL
(Resurfacing Projects w/ Widening or
with Existing Paved Shoulder having no dropoffs)

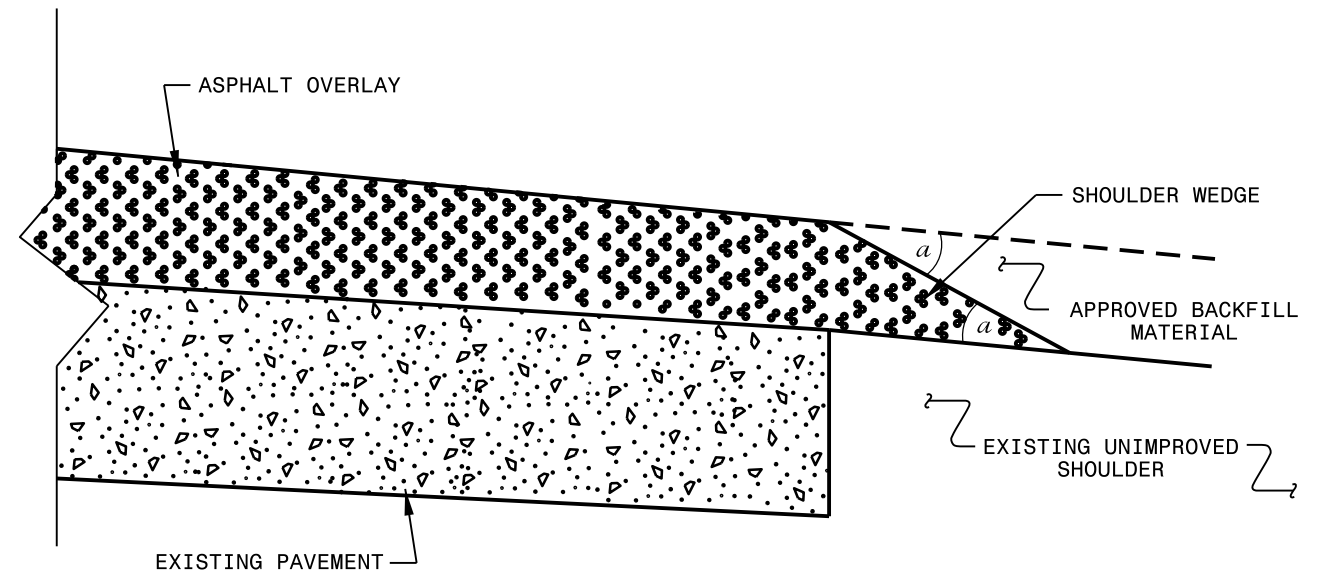

SHOULDER WEDGE DETAIL
(Resurfacing Projects w/ NO Widening)

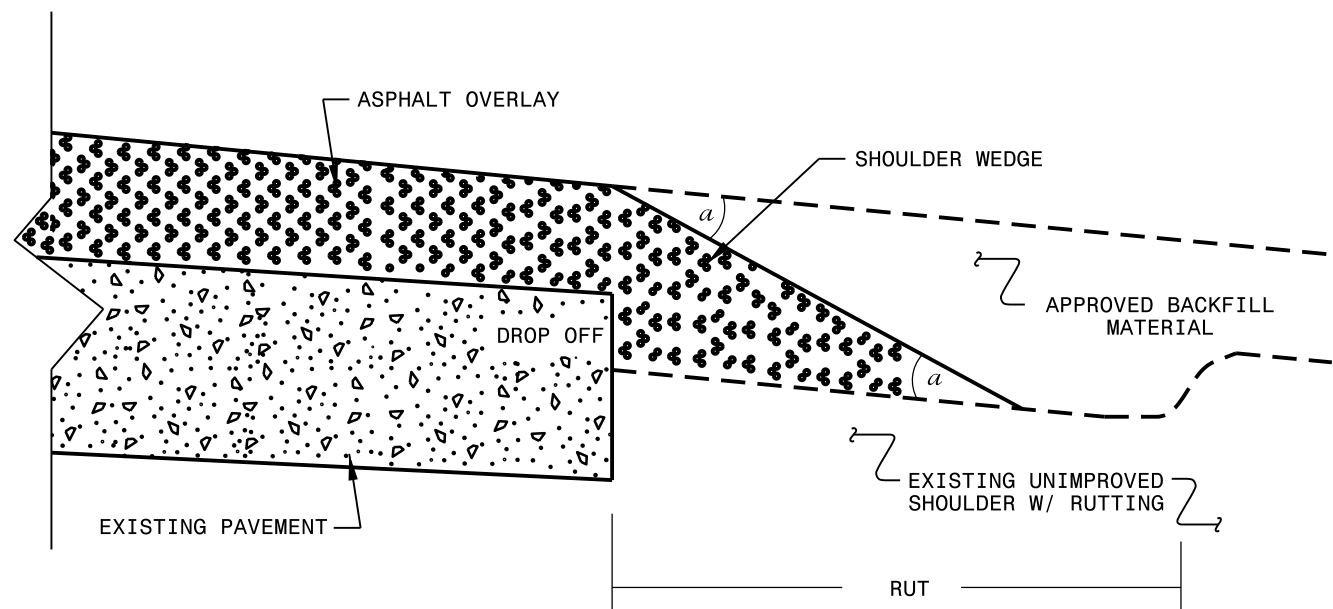

SHOULDER WEDGE DETAIL
(Resurfacing Adjacent to
Rutted Shoulder)

- SHOULDER WEDGE ANGLE = 30°

CONTRACT STANDARDS
AND DEVELOPMENT UNIT
Office 919-707-6950 FAX 919-250-4119

**SHOULDER WEDGE
DETAILS**

ORIGINAL BY: T.SPELL DATE: 7-19-11
 MODIFIED BY: DATE: 10/16/12
 CHECKED BY: DATE:
 FILE SPEC.: susr/details/stand/shoulderwedgedetail.dgn

SYSTEM: 11/15/11
 USER: T.SPELL
 FILE: 11/15/11

PROJECT NO.	SHEET NO.	TOTAL NO.
1CR.20081.68, etc.	9	9

SUMMARY OF QUANTITIES

PROJECT NO	COUNTY	MAP NO	ROUTE	DESCRIPTION	TYP NO	LANES	LANE TYPE	FINAL SURFACE TESTING REQUIRED	WARM MIX ASPHALT REQUIRED	LENGTH MI	WIDTH FT	MOBILIZATION LS	1½" MILLING SY	INCIDENTAL MILLING SY	SURFACE COURSE, S9.5B TONS	SURFACE COURSE, SF9.5A TONS	ASPHALT BINDER FOR PLANT MIX TONS	AC PLANT MIX (REPAIR) TONS	ASPHALT SURFACE TREATMENT, SPLIT SEAL SY	RETROFIT EXISTING CURB RAMPS EA	ADJ. OF MANHOLES EA	ADJ. OF METER OR VALVE BOX EA	TEMP TRAFFIC CONTROL LS	INDUCTIVE LOOP SAWCUT LF	LEAD-IN CABLE (14-2) LF
1CR.20081.68	Bertie	1	SR 1502	FROM SR NC 45 TO END	1	2	2WU	NO	NO	4.14	20	1		200	4,495		270						1		
1CR.20081.69	Bertie	2	SR 1363	FROM SR 1364 TO NC 45	2	2	2WU	NO	NO	1.25	19	*		75		1,050	70		14,000				*		
1CR.20081.70	Bertie	3	SR1322	FROM SR1321 TO HC LINE	3	2	2WU	NO	NO	0.43	19	*		80		386	26						*		
1CR.20081.71	Bertie	4	SR 1342	FROM SR 1312 TO SR 1314	2	2	2WU	NO	NO	1.63	18.5	*		60		1,332	89		17,700				*		
1CR.20081.72	Bertie	5	SR 1254	FROM NC 11 TO END	3	2	2WU	NO	NO	0.13	16.5	*		45		106	7						*		
1CR.20081.73	Bertie	6	SR 1228	FROM SR 1229 TO SR 1246	3	2	2WU	NO	NO	1.90	20	*		70		1,636	110						*		
1CR.20461.58	Hertford	7	SR 1409	FROM MALIBU DR. TO SR 1101	4	3	MU	NO	NO	1.21	36	*	26,000		2,334		140	60		6	15	18	*	120	20
1CR.20461.59	Hertford	8	SR 1403	FROM SR 1400 TO NC 45	1	2	2WU	NO	NO	1.28	20	*		650	1,486		89						*		
1CR.20461.60	Hertford	9	SR 1141	FROM SR 1146 TO SR 1146	2	2	2WU	NO	NO	0.56	16	*		130		408	27		5,300				*		
1CR.20461.61	Hertford	10	SR1427	FROM SR 1429 TO NC 561	2	2	2WU	NO	NO	1.93	20	*		120		1,680	113		11,800				*		
1CR.20461.62	Hertford	11	SR 1220	FROM NC 561 TO END	3	2	2WU	NO	NO	0.25	18	*		30		201	13						*		
1CR.20661.95	Northampton	12	SR1505	FROM US 158 TO SR 1504	1	2	2WU	NO	NO	3.80	20.5	*		460	4,181		251						*		
1CR.20661.96	Northampton	13	SR 1314	FROM NC 305 TO SR 1311	2	2	2WU	NO	NO	1.56	20	*		70		1,328	89		18,300				*		
1CR.20661.97	Northampton	14	SR 1218	FROM NC 46 TO SR 1613	3	2	2WU	NO	NO	0.62	19	*		55		502	34						*		
1CR.20661.98	Northampton	15	SR 1219	FROM SR 1209 TO END	3	2	2WU	NO	NO	0.64	19	*		30		514	34						*		
1CR.20661.99	Northampton	16	SR 1274	FROM SR 1263 TO END	3	2	2WU	NO	NO	0.87	19	*		50		719	48						*		
1CR.20661.100	Northampton	17	SR 1294	FROM SR 1274 TO END	3	2	2WU	NO	NO	0.14	17	*		30		175	12						*		
1CR.20661.101	Northampton	18	SR 1275	FROM SR 1274 TO END	3	2	2WU	NO	NO	0.64	17.5	*		30		513	34						*		
1CR.20661.102	Northampton	19	SR 1276	FORM SR 1275 TO END	3	2	2WU	NO	NO	0.24	17	*		30		218	15						*		
GRAND TOTAL										23.22		1	26,000	2,215	12,496	10,768	1,471	60	67,100	6	15	18	1	120	20